

Product Installation guide

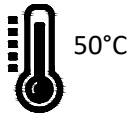

RECOMMENDED
OPERATION TEMPERATURE



MAKE SURE THE POWER
IS OFF DURING INSTALLATION



120-277V~
50/60 Hz

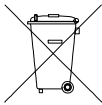

RISK OF FIRE AND
ELECTRICAL SHOCK

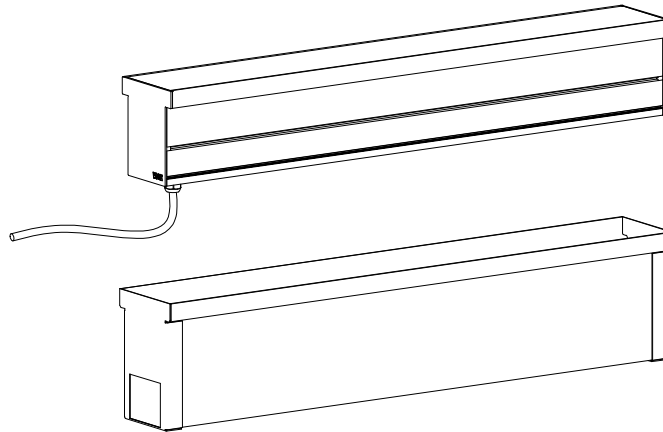

INSTALLATION INSTRUCTIONS

DISCLAIMER

Please read all instructions before beginning installation:

1. Turn off electrical power before starting the installation of the light fixture.
2. The feeding voltage must not exceed the specified fixture voltage.
3. This product must be installed by an eligible electrician.
4. Make sure the luminaire is mounted to a secure structure. Mounting the fixture in inappropriate way could lead to serious injury.
5. This luminaire is class 1, it must be earthed in a reliable way.
6. Wear gloves and safety glasses at all times when removing the luminaire from carton, installing, servicing or performing maintenance
7. Do not install damaged product! This luminaire is properly packed to avoid being damaged during transit. Inspect to confirm before installation. Any damaged or broken part during or after assembly should be replaced.
8. Unauthorized repairs or modifications will void warranty.

Section View:

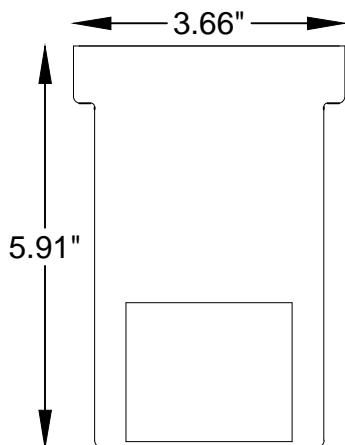

Inground Deep

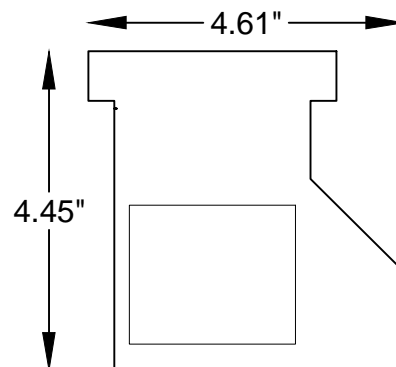

Inground Shallow

Dimensions in inch

Product Installation guide

Housing Dimension						
Length Code	Inground Deep			Inground Shallow		
	Length	Width	Depth	Length	Width	Depth
12 in	12.48 in	3.66 in	5.91 in	14.65 in	4.61 in	4.45 in
24 in	24.06 in	3.66 in	5.91 in	26.22 in	4.61 in	4.45 in
36 in	35.63 in	3.66 in	5.91 in	37.80 in	4.61 in	4.45 in
48 in	47.20 in	3.66 in	5.91 in	49.37 in	4.61 in	4.45 in
60 in	58.78 in	3.66 in	5.91 in	60.94 in	4.61 in	4.45 in

Installing the housing

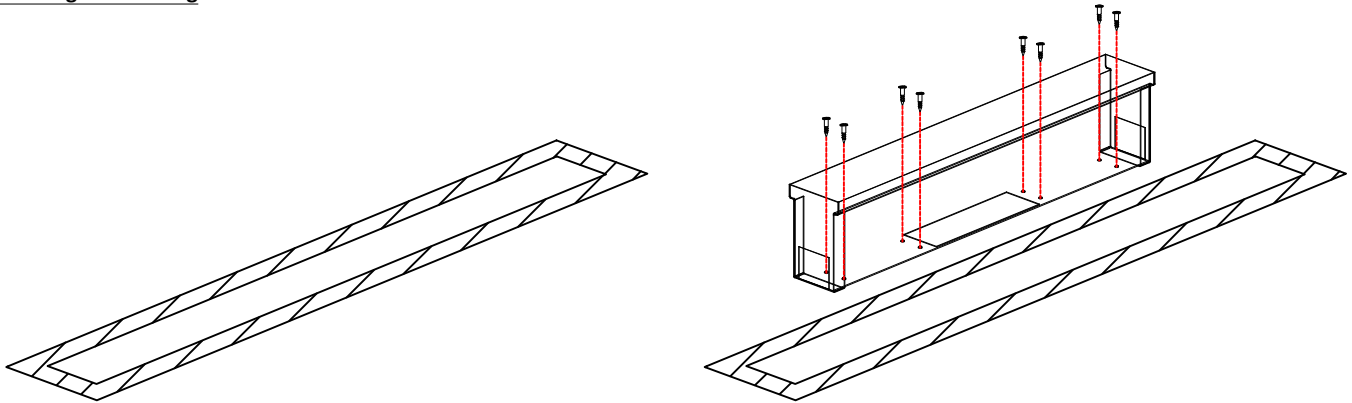

- 1 Dig in the Ground to get enough space to install the housing.
- 2 Put the housing in the hole and fix it with screws* (* Optional)
- 3 Make Sure the surface of the luminaire is flushed with the ground

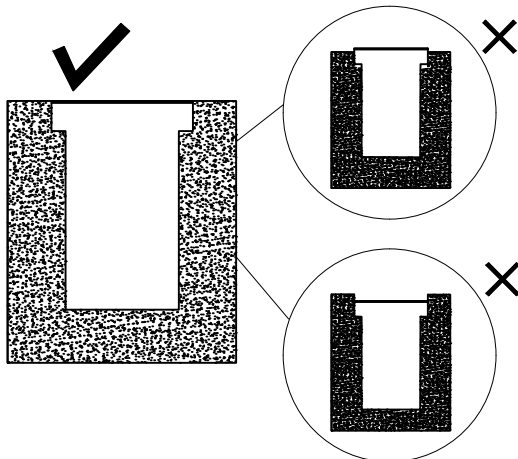

A proper water drainage system is required with a minimum rate of 0.08 GAL (0.33 Liter) per minute per meter as shown below:

Length	Minimum Drainage Rate
1 ft (30cm)	0.026 gal/min (0.1 l/min)
2 ft (60cm)	0.053 gal/min (0.2 l/min)
3 ft (90 cm)	0.079 gal/min (0.3 l/min)
4 ft (120 cm)	0.105 gal/min (0.4 l/min)
5 ft (150 cm)	0.132 gal/min (0.5 l/min)

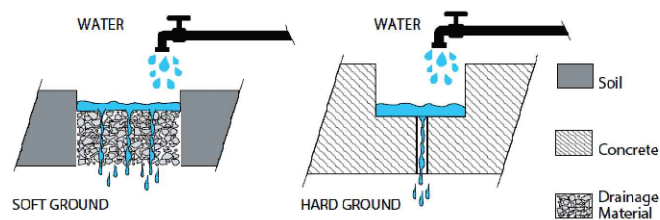

WARNING :
FAILURE TO PROVIDE
PROPER DRAINAGE
WILL VOID PRODUCT
WARRANTY

Product Installation guide

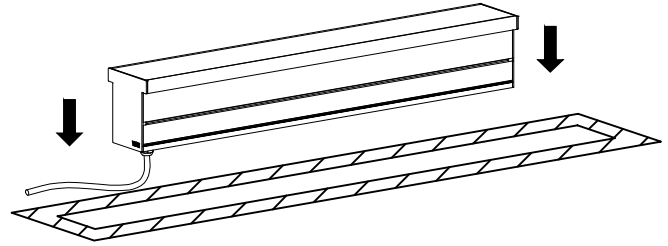
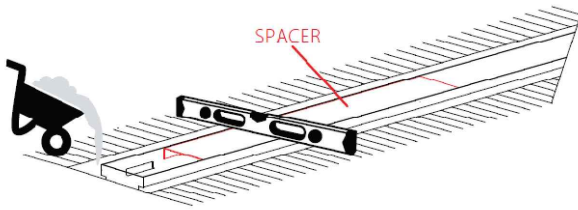

4 Cover with the spacer provided with the luminaire to prevent any debris from getting into the housing.

5 Put the fixture in the housing.

Asymmetrical optics:

Below section views shows the light direction and the power feeding location for the asymmetrical optic.

Light Direction

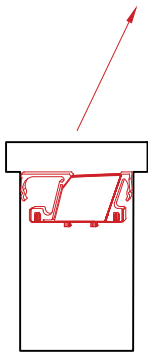

Grazing Baffles

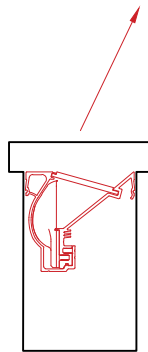

CutOff Washer

Light Direction

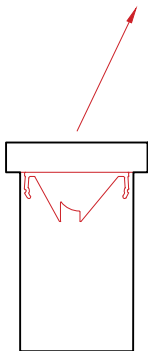

Asymmetrical Lens

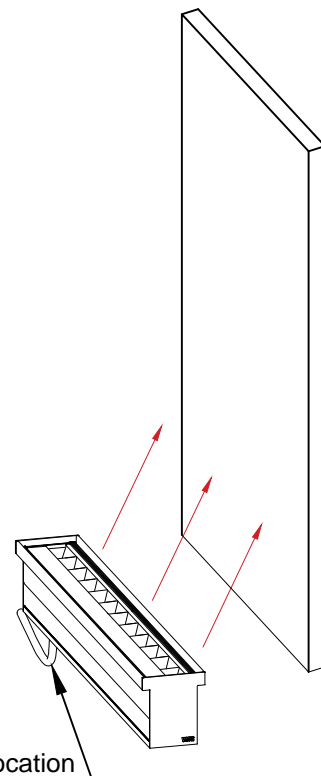

Power feeding location

Product Installation guide

Electrical Wiring for continuous run

For Non Dimmable

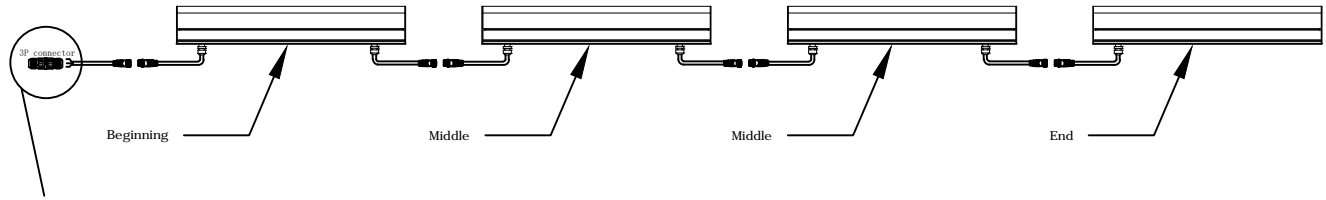

Black :Line
White : Neutral
Green : Ground



Do not exceed 450W per feeding.

Electrical Wiring for continuous run

For DALI or 0/1-10V Dimmable

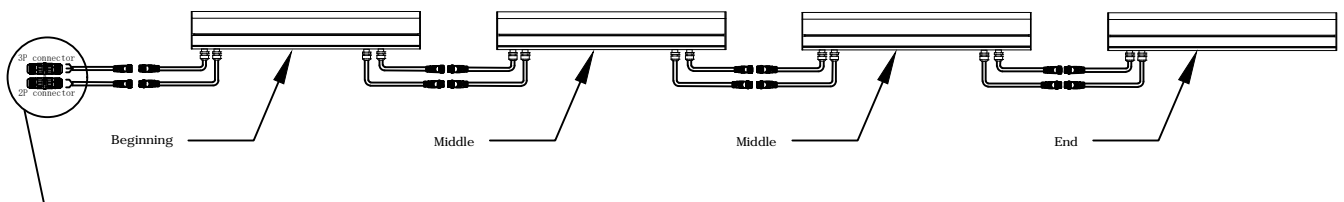

Black :Line
White : Neutral
Green : Ground



White : DIM +
Black : DIM -



Do not exceed 450W per feeding.